

FIRST FLOOR PLAN
Scale 1:100
Type H (End Terrace) Floor area - 57m² / 613sq.ft
Type H (Mid Terrace) Floor area - 57m² / 613sq.ft
Type H (Mid Terrace) Floor area - 57m² / 613sq.ft
Type H (End Terrace) Floor area - 57m² / 613sq.ft

FIRST FLOOR PLAN - 1:200@A3

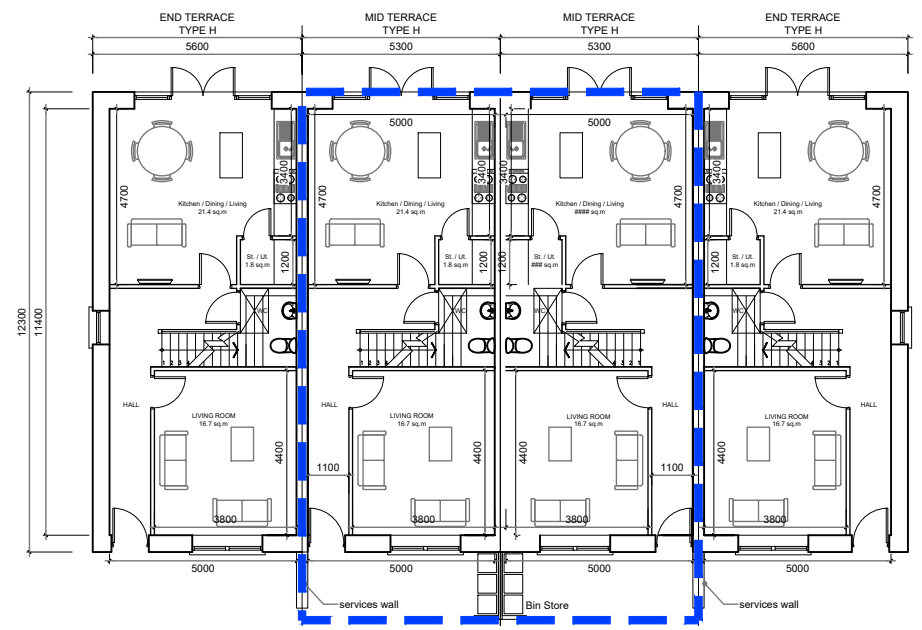

GROUND FLOOR PLAN
Scale 1:100
Type H (End Terrace) Floor area - 57m² / 613sq.ft
Type H (Mid Terrace) Floor area - 57m² / 613sq.ft
Type H (Mid Terrace) Floor area - 57m² / 613sq.ft
Type H (End Terrace) Floor area - 57m² / 613sq.ft
OA 114.0m² / 1226sq.ft
OA 114.0m² / 1226sq.ft
OA 114.0m² / 1226sq.ft
OA 114.0m² / 1226sq.ft

GROUND FLOOR PLAN - 1:200@A3

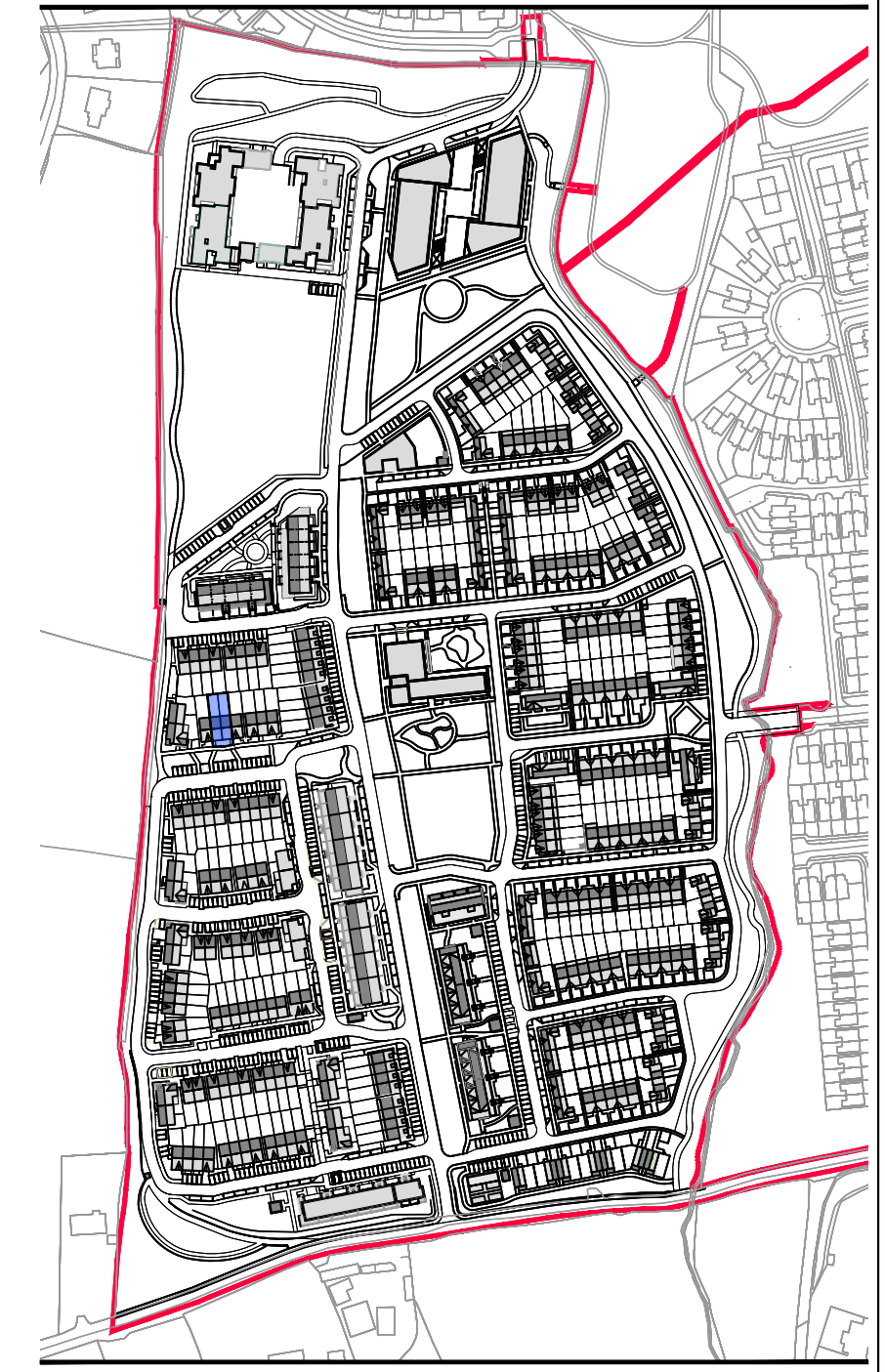

SCHEDULE OF ACCOMODATION PART V - AFFORDABLE
HOUSE TYPE H (MID TERRACE) 2 UNITS
HOUSE TYPE 'H' - 2 BED - (114 Sq.m) - 2 No.

NOTE:
DO NOT SCALE FROM DRAWINGS. WORK TO FIGURED DIMENSIONS ONLY. ARCHITECT TO BE NOTIFIED OF ALL DISCREPANCIES.

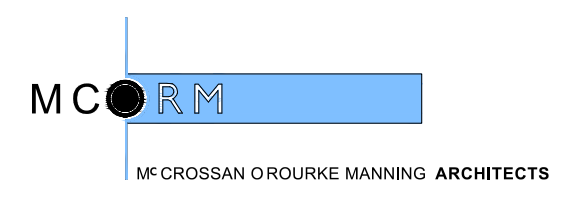

PROJECT TITLE: Residential development @ Boherboy Lands	DATE: Sept '21	DRAWN BY: SM
DRAWING TITLE: Part V - House Type H - Floor Plans	SCALE: 1:200@A3	REVISION:
Albert Place West, Harcourt Lane, Dublin 2, Ireland. Tel: 01-4788700 Fax: 01-4788711 E-Mail: arch@mcorm.com	JOB NO: 20002	DRAWING NO: PV14